

ECD		REVISIONS	
REV.	DESCRIPTION	DATE	APPROVED
A	RELEASE FOR PRODUCTION	03-14-17	

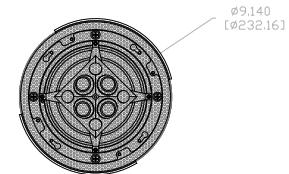

NOTES:

- 1: MATERIAL - 0.125" THICK 5052 ALUMINUM UNLESS OTHERWISE SPECIFIED
- 2: FINISH: TBD
- 3: 1 METER OF PICTAIL WIRE

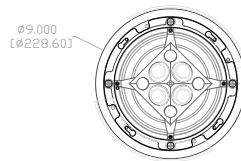
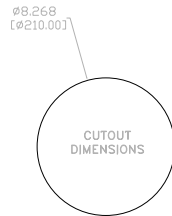
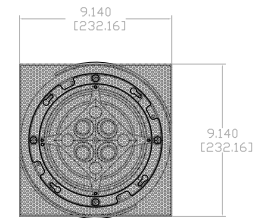
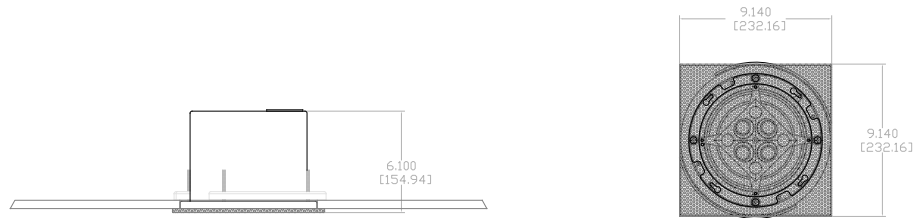
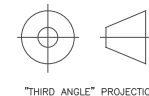

"THIRD ANGLE" PROJECTION

PROPRIETARY INFORMATION
 THE DESIGNS, INFORMATION, AND
 DATA CONTAINED HEREIN ARE
 PROPRIETARY AND ARE
 SUBMITTED IN CONFIDENCE, AND
 SHALL NOT BE DISCLOSED, USED
 OR DUPLICATED IN WHOLE OR IN
 PART, FOR ANY PURPOSES WHAT-
 SOEVER OF JAMES LOUDSPEAKER
 LLC, 535 AIRPARK RD, NAPA, CA
 94558. THIS LEGEND SHALL BE
 MARKED ON ANY REPRODUCTIONS
 HEREOF IN WHOLE OR IN PART.
 RECEIPT OF THIS DOCUMENT
 SHALL BE DEEMED TO AN
 ACCEPTANCE OF THE CONDITIONS
 SPECIFIED HEREIN.

JAMES LOUDSPEAKER

EXTERNAL DIMENSIONS	
P/N: 0XC620 R/S	DWR #: 170314-K301
REVISIONS:	
DRAWN BY: K. DUNLEA	FILE:
DATE: 03-14-17	SCALE:
APPROVED:	
DRAFTING APPROVED:	
DO NOT SCALE DRAWING	
DRAWING NOT TO BE USED FOR CNC	
TOLERANCES: ANG ± = .5° FRACT. ± = 1/32	
DECIMALS: .XX ± = .01 .XXX ± = .005	
REVISION: A	SHEET 1 OF 10